

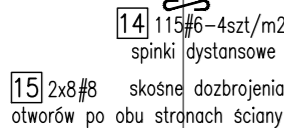







## 1:50

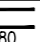
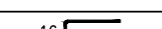
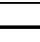
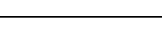

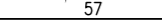
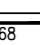
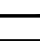
Stal zbrojeniowa					
Nr pręta	Ilość	Stal		Długość m	Kształt pręta
		A-IIIIN mm	A-I mm		
1	56	12		5,04	
2	6	12		1,76	16 
3	12	12		3,16	
4	6	12		1,00	16 
5	38	10		6,97	
6	12	10		3,83	
7	12	10		2,07	
8	35	10		0,89	19 
9	23	10		1,33	19 
10	4	12		7,96	
11	6	12		1,36	68 
12	8	12		5,34	
13	4	12		1,44	
14	115	6		0,35	
15	16	8		0,60	
16	8	14		2,00	
17	4	12		5,11	
18	4	12		4,38	48 
PODSUMOWANIE ZESTAWIENIA					
Średnica	Stal	Długość [m]		Masa 1m (kg/m)	Ciężar [kg]
6	A-IIIIN	40,25		0,222	8,9
8	A-IIIIN	9,60		0,395	3,8
10	A-IIIIN	397,40		0,617	245,0
12	A-IIIIN	463,16		0,888	411,2
14	A-IIIIN	16,00		1,208	19,3
Masa stal A-I		0 kg			
Masa stal A-IIIIN		688,3 kg			
Masa całkowita		688,3 kg			

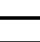
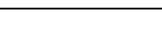
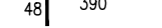
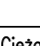
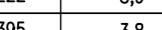
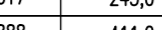
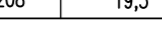
## 1:20

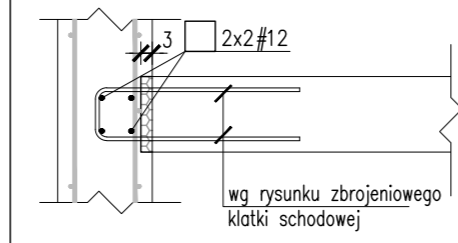

**Abstract**

Mapa sytuacyjna / Location map

The map shows a complex of buildings with various rooms and corridors. The building is situated in an urban environment, with streets and other buildings visible in the background. A compass rose is located in the top left corner, indicating the orientation of the map.

JSK Architekti Sp. z o.o.  
ul. Żwirki i Wigury 18  
02-092 Warszawa  
tel. 0048 22 660 30 00  
e-mail: jsk@jsk-waw.pl

ul. Nowoursynowska 166 02-787 Warszawa	02-787 Warszawa
---	-----------------

FORT POLSKA Sp. z o.o. ul. Nowotoruńska 8	mgr inż. Paweł Lachowicz Upr. bud. nr: ABIT-II-7131-12/2000
--	--

e-mail: pocza@fort.pl	mgr inż. Sebastian Kulikowski Upr. bud. nr: KUP/0078/POOK/14
-----------------------	---

<b>PROJEKT PRZETARGOWY</b>	<b>KONSTRUKCJA</b>	mgr inż. Katarzyna Lisowska	26/05/2023
----------------------------	--------------------	-----------------------------------	------------

Zawartość rysunku/ Drawing content	Sprawdził/ Checked by	Skala/ Scale
	mar inż.	

[illegible]

Numer projektu Project number	Nazwa Budynku Building Name	Faza projektu Project phase	Branża Branch	Rodzaj rysunku Drawing type	Poziom Level	Nr rysunku Drawing nr	Nr rewizji Revision nr
----------------------------------	--------------------------------	--------------------------------	------------------	--------------------------------	-----------------	--------------------------	---------------------------

Nominalna wartość otulin ( $C_{nom}$ ) przyjęta do obliczeń wynosi  $C_{nom} = C_{min} + \Delta c$ , gdzie  
 $C_{min}$  – wg tabeli  
 $\Delta c$  – 5mm

a

1	←	Rozstaw [cm]
10	←	Średnica [mm]
#12-15	←	Stal (# = A-IIIIN; $\phi = A-I$ )
	←	Ilość
	←	Numer

Wymiary prętów (X, Y, Z) – podano w osiach

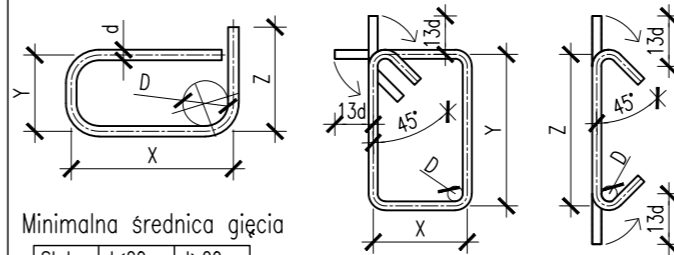

Stal	$d < 20$	$d \geq 20$
A-I	$D = 2,5d$	$D = 5d$
A-IIIN	$D = 4d$	$D = 7d$

Stal	$d < 20$	$d \geq 20$
A-I	$D = 2,5d$	$D = 5d$
A-III	$D = 4d$	$D = 7d$

Długość strzemion i szpilek pokazana w zestawieniu uwzględnia zapas na każdy hak =  $13d$  ( $d$  – średnica).

### DETAL ROZKŁADU ZBROJENIA

POZIOME ZBROJENIE

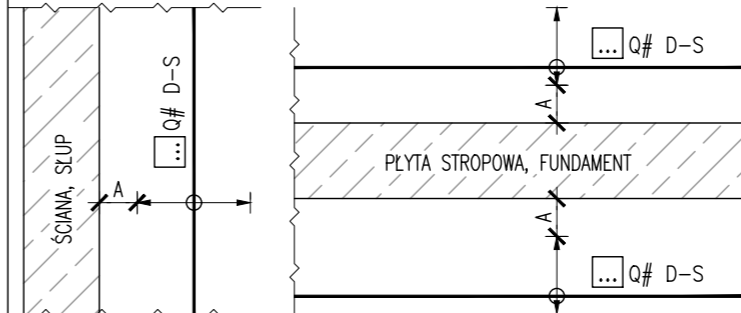

A – nie mniej niż otulina, nie więcej niż  $S/2$ , nie więcej niż 10 cm;  
S – Rozstaw podstawowy zbrojenia;  
D – Średnica zbrojenia; Q – Ilość zbrojenia;